

## Cleaning & Maintenance

The Karndean floor Cleaning and Maintenance Guide is designed to show you how to get the best from your new Karndean floor. Karndean floors are very hardwearing and like all vinyl products, regular maintenance will enhance the beauty and durability of your new floor.

We recommend that you order a 'Clean Start' pack with your new Karndean floor. You will be able to order extra bottles of the individual cleaning products from Completely Flooring.

### Clean Start pack contains:

750ml Basic Cleaner & Stripper  
750ml Dim Glow Floor Protector  
750ml Routine Cleaner  
1 x Applicator  
1 x Green pad  
(for use with Basic Cleaner)  
1 x White pad  
(for use with Dim Glow)  
1 x Set furniture protectors



### Stage 1 – Basic Cleaner and Stripper

#### Preparation

Newly laid floors should be left for at least 24 hours before you replace furniture or clean the floor. Before using our cleaning and maintenance products, you should sweep the floor with a soft brush.

Following installation, use to remove all remains of adhesive.

Subsequently, use to remove previous applications of Dim Glow floor protector.



Dilute Basic Cleaner and Stripper approximately 1:5 with water (4 divider lines [200ml] to one litre of water – covers approx. 10m<sup>2</sup>). Spread solution liberally over the floor with mop.

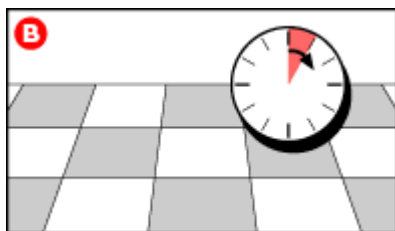

Leave to work for approximately 5 minutes.

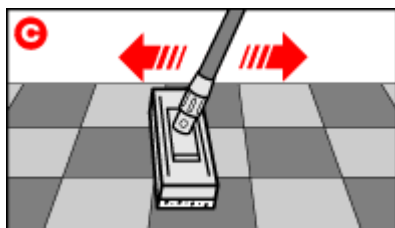

Scrub the floor with the blue applicator and green pad.

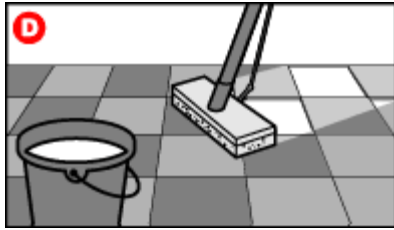

Remove residue with mop, then rinse thoroughly with clean water.

Basic Cleaner and Stripper should NOT be allowed to dry on the floor. While applying Basic Cleaner and Stripper wear rubber gloves. For the removal of stubborn marks, use Basic Cleaner and Stripper undiluted.

## Stage 2 – Dim Glow Floor Protector

Dim Glow Floor Protector creates a matt, anti-slip film finish to help protect your floor from marks and fine scratches, and helps to simplify routine cleaning. Before proceeding with application ensure the floor is completely dry and free of all traces of Basic Cleaner and Stripper.

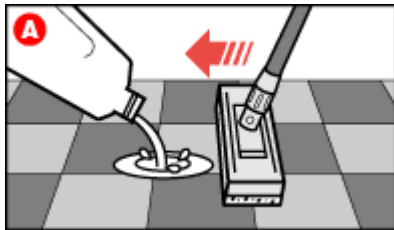

Using the blue applicator with the white pad, spread a thin and even layer of undiluted Dim Glow floor protector, in one direction.

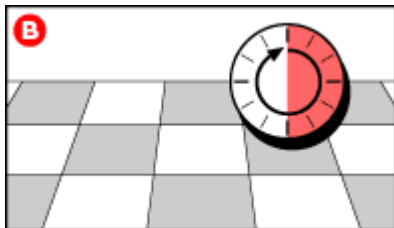

Leave this layer to dry for approximately 30 minutes...

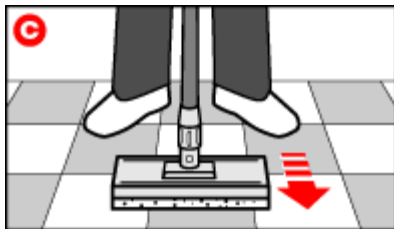

...then repeat the process in a transverse direction. **(IMPORTANT:** white pad must be rinsed thoroughly immediately afterwards, for future use).

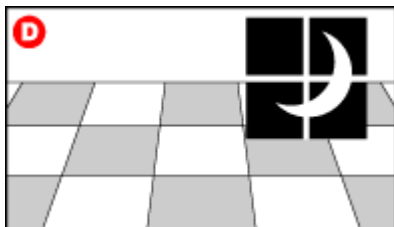

Leave to dry without walking on the surface for at least 6 hours, or preferably overnight.

Note: When, after a period of time, the Dim Glow needs replenishing, begin the process from stage 1 again. To maintain the protective layer, the Dim Glow floor protector will need to be stripped and reapplied every 6 months or so.

### Stage 3 – Routine Cleaner

Use regularly for easy cleaning of your Karndean floor.



Use 50ml (1 divider line) in a bucket with about 8 to 10 litres of water.

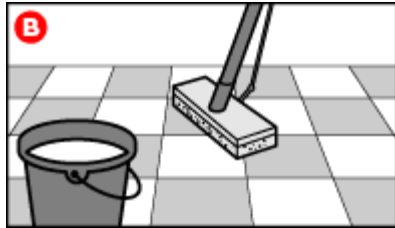

Keeping the mop damp, not wet, mop over the entire floor area. Leave to dry.

**Attention:** Keep locked up and out of reach of children.

### Stage 3 – Routine Cleaner

Use regularly for easy cleaning of your Karndean floor.

#### Protecting your floor

##### Do...

Use quality fibre mats at entrances to minimise dirt and grit being brought in from outside.

(Warning: Avoid rubber-backed mats as some types can cause permanent floor discolouration.)

Use protective pads under furniture legs to prevent fine scratches.

Use load-bearing castors to prevent indentation from heavy items of furniture.

Mop up spillages as soon as possible to prevent spots becoming stains. Use of the Dim Glow floor protector should ensure better protection from most substances.

##### Do Not...

Slide or drag appliances or furniture across the floor.

Allow cigarettes or other hot items to come into contact with the floor, as they can cause permanent damage.

Apply thick coatings of Dim Glow floor protector. Two thin coats as per our instructions is sufficient.

Use non- Karndean cleaning products. Some cleaning products contain agents that can damage the floor.

Allow silicone-based products such as furniture polish or glass cleaner to come into contact with the floor. These can make the floor very slippery.

Allow rubber backed mats or rubber footed furniture to come into contact with the floor. Permanent discolouration may occur.